

- Flapper isolation valves are designed for use with neutral or highly aggressive liquids in analytical and medical systems
- Special Flapper mechanism results in no pumping or sticking effects
- Reduced heat transfer between control mechanism and fluid make them ideal for use with heat-sensitive reagents and biological samples
- Hermetic separation of control mechanism prevents particulate contamination caused by friction of moving parts, assuring maximum purity of liquid samples
- Excellent self-draining capability and easy-to-flush low-volume internal cavity make these valves ideal in application where cross-contamination must be minimized
- Meets all relevant CE directives, and is RoHS compliant
- Typical applications include:
 - In-vitro Diagnostics
 - Hematology
 - DNA Sequencing
 - Industrial Liquid Analyzers

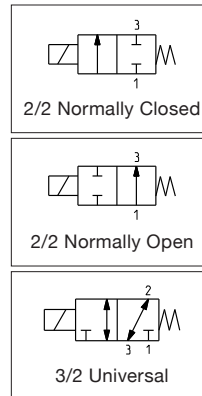

Fluids*	Temperature Range	Seal Materials*
Liquids or Gases ¹	5 °C to 50 °C (41 °F to 122 °F)	FFKM
		FKM
		EPDM

¹ Filtration: 50µm

* Ensure that the compatibility of the fluids in contact with the materials is verified

General Valve Information	
Body	PEEK
Seals	FFKM (FKM/EPDM)
Diaphragm	FFKM (FKM/EPDM)
Others	Stainless Steel
Response Time	< 20ms
Internal Volume	75µl
Max. Viscosity	20 cSt (mm ² /s)

Electrical Characteristics	
Coil Insulation Class	F
Connector	Spade terminals or Lead wires ²
Connector Specification	Spade terminals: DIN 46340, lead wires: 24 AWG
Electrical Safety	IEC 335
Electrical Enclosure Protection	Molded IP40 spade terminals (EN 60529) Molded IP66 lead wires (EN 60529)
Standard Voltages*	12 VDC, 24 VDC (-5%/+10%)

Electrical Connection	Power Ratings			Ambient Temperature Range	Type ¹
	Inrush	Holding	Hot/Cold		
	VA	VA	W	W	
S0	-	-	-	5 to 50 (41 to 122)	01
L0	-	-	-		4

* Other voltages on request

¹ Refer to the drawings on following pages

² 0.5m (19.7in) lead wires

Functional Principle

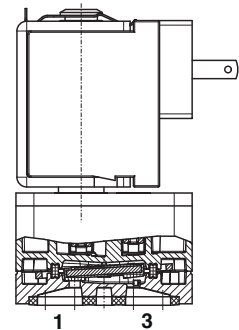

Function 2/2 NC

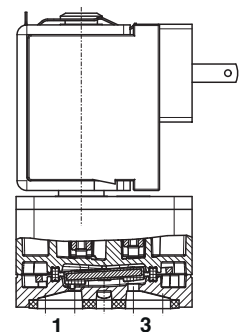

Function 2/2 NO

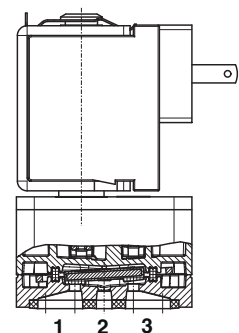

Function 3/2 U

Specifications							
Connection	Orifice Size mm (inches)	Flow Coefficient		Pressure Differential bar (psi)		Power Coil (W)	Catalog Number Body PEEK
		Kv (m3/h)	Cv	min.	max. gases or liquids		
2/2 NC - Normally Closed							
Pad Mounting ¹	0.8 (0.031)	0.021	0.024	-0.9 (-13)	8 (116)	4	R068A212xxx00xx
	1.2 (0.047)	0.036	0.042	-0.9 (-13)	4 (58)	4	R068A214xxx00xx
	1.6 (0.063)	0.042	0.046	-0.9 (-13)	2 (29)	4	R068A216xxx00xx
1/4-28 UNF	0.8 (0.031)	0.021	0.024	-0.9 (-13)	8 (116)	4	0068A212xxx00xx
	1.2 (0.047)	0.036	0.042	-0.9 (-13)	4 (58)	4	0068A214xxx00xx
	1.6 (0.063)	0.042	0.046	-0.9 (-13)	2 (29)	4	0068A216xxx00xx
Push-in Hose Connection	0.8 (0.031)	0.021	0.024	-0.9 (-13)	8 (116)	4	6068A212xxx00xx
	1.2 (0.047)	0.036	0.042	-0.9 (-13)	4 (58)	4	6068A214xxx00xx
	1.6 (0.063)	0.042	0.046	-0.9 (-13)	2 (29)	4	6068A216xxx00xx
2/2 NO - Normally Open							
Pad Mounting ¹	0.8 (0.031)	0.021	0.024	-0.9 (-13)	8 (116)	4	R068A222xxx00xx
	1.2 (0.047)	0.036	0.042	-0.9 (-13)	4 (58)	4	R068A224xxx00xx
	1.6 (0.063)	0.051	0.059	-0.9 (-13)	2 (29)	4	R068A226xxx00xx
1/4-28 UNF	0.8 (0.031)	0.021	0.024	-0.9 (-13)	8 (116)	4	0068A222xxx00xx
	1.2 (0.047)	0.036	0.042	-0.9 (-13)	4 (58)	4	0068A224xxx00xx
	1.6 (0.063)	0.051	0.059	-0.9 (-13)	2 (29)	4	0068A226xxx00xx
Push-in Hose Connection	0.8 (0.031)	0.021	0.024	-0.9 (-13)	8 (116)	4	6068A222xxx00xx
	1.2 (0.047)	0.036	0.042	-0.9 (-13)	4 (58)	4	6068A224xxx00xx
	1.6 (0.063)	0.051	0.059	-0.9 (-13)	2 (29)	4	6068A226xxx00xx
3/2 U-Universal							
Pad Mounting ¹	0.8 (0.031)	0.021	0.024	-0.9 (-13)	8 (116)	4	R068A232xxx00xx
	1.2 (0.047)	0.036	0.042	-0.9 (-13)	4 (58)	4	R068A234xxx00xx
	1.6 (0.063)	0.051	0.059	-0.9 (-13)	2 (29)	4	R068A236xxx00xx
1/4-28 UNF	0.8 (0.031)	0.021	0.024	-0.9 (-13)	8 (116)	4	0068A232xxx00xx
	1.2 (0.047)	0.036	0.042	-0.9 (-13)	4 (58)	4	0068A234xxx00xx
	1.6 (0.063)	0.051	0.059	-0.9 (-13)	2 (29)	4	0068A236xxx00xx
Push-in Hose Connection	0.8 (0.031)	0.021	0.024	-0.9 (-13)	8 (116)	4	6068A232xxx00xx
	1.2 (0.047)	0.036	0.042	-0.9 (-13)	4 (58)	4	6068A234xxx00xx
	1.6 (0.063)	0.051	0.059	-0.9 (-13)	2 (29)	4	6068A236xxx00xx

¹ 2 hexagon socket head cap mounting screws M2.5, stainless steel, supplied

How to Order

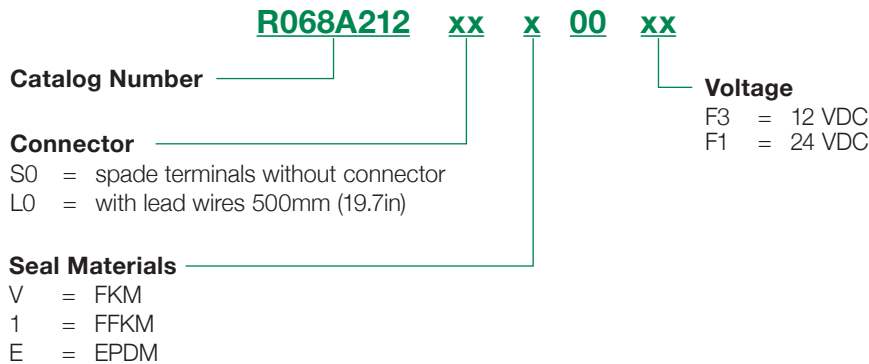

Ordering Example: **R068A216S0E00F1** = 2-way NC (normally closed), orifice size 1.6mm (0.063in), pad-mounting body width 16mm (0.63in), with spade terminals without connector, EPDM seals, 24 VDC

Options

- Subbases available on request

Installation

- The solenoid valves can be mounted in any position without affecting operation
- Pad-mounting solenoid valve supplied with seal

Dimensions: mm (inches)

Dimensional Drawings

Type 01

Solenoid with spade terminals (S0)
DIN 46340
IP40

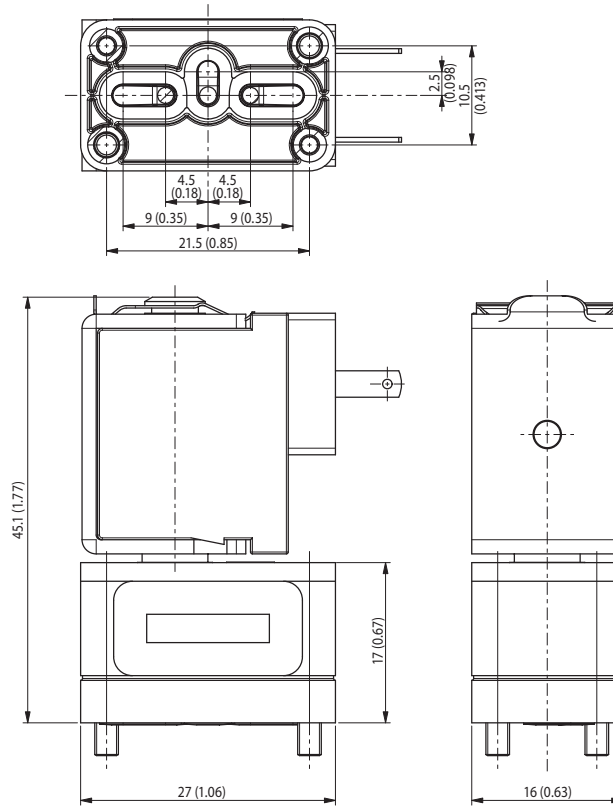

Type 02

Solenoid with lead wires (L0)
24 AWG, lead wires:
500mm (19.7in) long
IP66

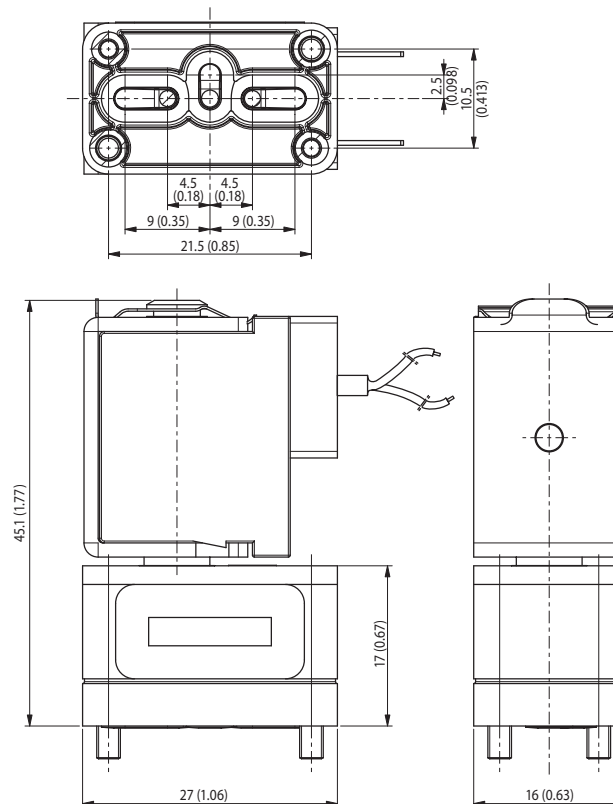

Dimensions: mm (inches)

Dimensional Drawings

Subbase Mounting Pattern

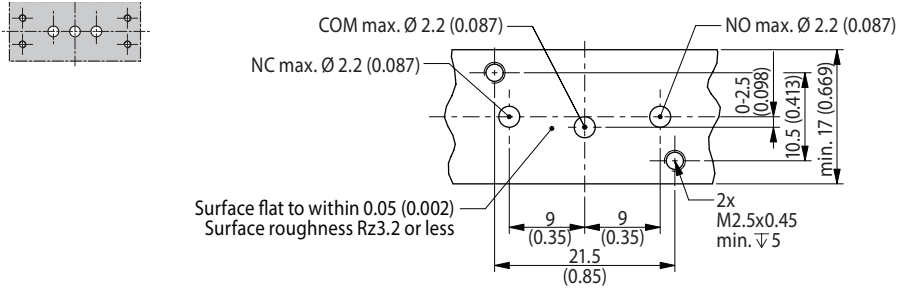

1/4 - 28 UNF Version

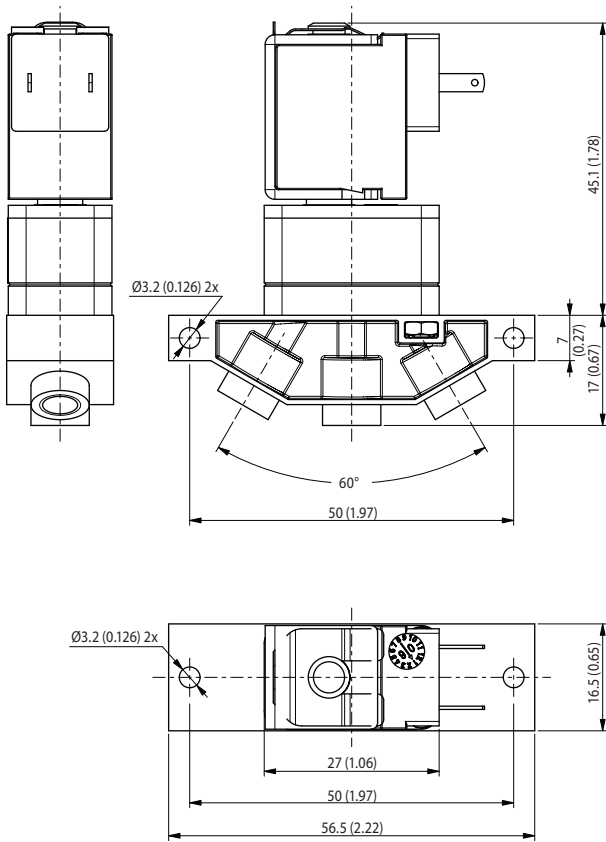

Version with Push-in Hose Connection

